

DI GROOVED FITTINGS-LIGHT-DUTY TEE

Type: 130S

Doc No: DS-400-130S-01-E

1.0 PRODUCT OVERVIEW

The light-duty tee product is used for grooved pipe connection, mainly in the grooved pipe end where the main pipe needs branch pipe. The diameter of the main pipe and branch pipe is the same.



Dimensions:

2"(DN50)– 8"(DN200)

Design Standard:

ISO6182, AWWA C606, GB 5135.11

Connection Standard:

ASME B36.10, ASTM A53-A53M, ISO 4200

Working Pressure:

175PSI-300PSI

Application:

The light-duty tee product is suitable for medium and low pressure pipeline systems with nominal pressure 175-300 PSI, nominal size DN50-DN200, temperature range of - 20 °C-+180°C, which are widely applied in water supply and drainage, fire-fighting, air conditioning, etc.

Pipe Material:

Welded and seamless rolled steel pipes according to ASME B36.10, ASTM A53-A53M, ISO 4200, GB/T 21835

Sign Off:

Owner: _____ Contractor: _____ Engineer: _____
Location: _____ Date: _____ Approved & Date: _____

Surface Treatment:

- Electrophoretic painting
- Epoxy power painting
- Hot-dip galvanizing
- Black
- Others would be available upon clients' detailed request

2.0 APPROVALS



3.0 SPECIFICATIONS-MATERIAL

Ductile iron according to ASTM A536, grade 65-45-12. The nodularity is more than 90%, ensuring excellent physical and mechanical properties.

4.0 DIMENSIONS AND PERFORMANCE

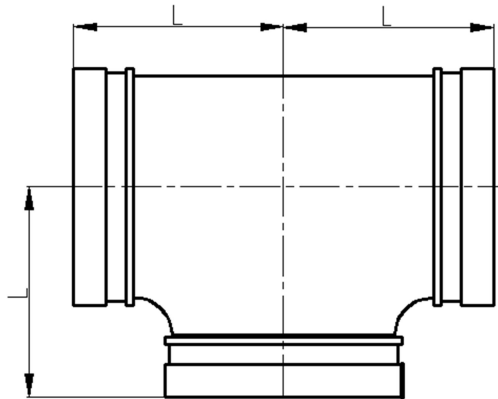

Sign Off:

Owner: _____ Contractor: _____ Engineer: _____
 Location: _____ Date: _____ Approved & Date: _____

Nominal Size	Pipe O.D.	Working Pressure	Dimensions L
mm/in	mm/in	PSI/MPa	mm/in
50 2	57.0 2.244	300 2.07	70 2.75
50 2	60.3 2.375	300 2.07	70 2.75
65 2½	73 2.875	300 2.07	76 3.00
65 2½	76.1 3.000	300 2.07	76 3.00
80 3	88.9 3.500	300 2.07	85.5 3.37
100 4	108 4.250	500 3.45	101 3.98
100 4	114.3 4.500	300 2.07	101 3.98
125 5	139.7 5.500	300 2.07	124 4.88
150 6	159 6.260	300 2.07	140 5.50
150 6	165.1 6.500	300 2.07	140 5.50
150 6	168.3 6.625	300 2.07	140 5.5
200 8	216.3 8.516	300 2.07	175 6.89
200 8	219.1 8.625	300 2.07	175 6.89

5.0 REFERENCE MATERIALS

Approved certification for Grooved Fittings and Couplings

I-JM-Grooved fitting: Installation Instructions for grooved fittings and couplings

Sign Off:

Owner: _____ Contractor: _____
 Location: _____ Date: _____

Engineer: _____
 Approved & Date: _____